

REV	ECN NO.	DESCRIPTION	DRN	APP'D	DATE

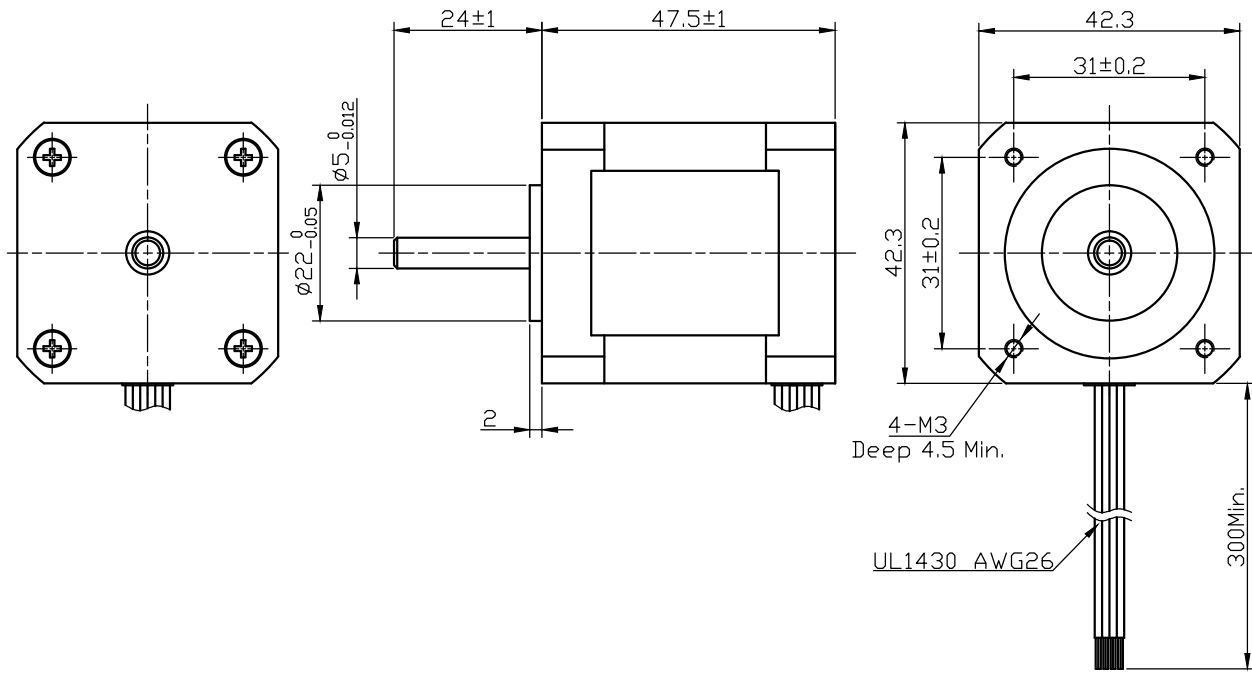

Wiring Diagram(接线图)

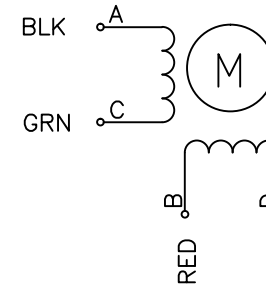

Exciting Sequence (励磁顺序)

CW DIRECTION	STEP	A	C	B	D
↓	1	+		+	
	2		+	+	
	3		+		+
	4	+			+
	1	+		+	

CW, see from flange side  
(顺时针, 从法兰侧看)

SPECIFICATION

STEP ANGLE	步距角	0.9°/full step(差步)	PERMISSIBLE RADIAL+AXIAL FORCE (允许的轴向往复力)
STEP ANGLE ACCURACY	步距角精度	±5%	
NUMBER OF PHASE	绕组相数	2	
RATED VOLTAGE	额定电压	3.0 VDC	
RATED CURRENT	额定电流	1.68 A	
RESISTANCE/PHASE	每相电阻	1.8±10% ohms@20°C	
INDUCTANCE/PHASE	每相电感	5.0±20% mH@1kHz	
HOLDING TORQUE	保持转矩	0.44 N.m	
PULL OUT TORQUE	运行转矩		
BACK EMF	反电动势		
DETENT TORQUE	定位转矩		
ROTOR INERTIA	转子转动惯量	54 g.cm <sup>2</sup>	
WEIGHT	重量	220 g	
TEMPERATURE RISE	温升	Less than 80K(小于80度)	AXIAL-FORCE 轴向压力
SOURCE VOLTAGE	驱动器电压	24 VDC	DISTANCE 距离
INSULATION CLASS	绝缘等级	B 130°C	RADIAL-FORCE 径向压力
DIELECTRIC STRENGTH	介电强度	500VAC 1MIN	Fa=10 N Max.
INSULATION RESISTANCE	绝缘电阻	100MΩhm @500VDC	a=20 mm
IP CODE	防护等级	IP30	Fr=28 N Max.
OPERATION AMBIENT	使用环境	Ambient temperature:-20...+50°C, humidity Max. 85%(No condensation)	SHAFT RADIAL PLAY 径向间隙
STORAGE AMBIENT	存储环境	Ambient temperature:-20...+85°C, humidity Max. 85%(No condensation)	SHAFT AXIAL PLAY 轴向间隙
			0.02mm Max. @4N
			0.08mm Max. @4N

DESIGN		DATE		P/N.	
				3.1.01.042,***	
UNLESS OTHERWISE SPECIFIED TOLERANCES:				TITLE	
DECIMALS: .x ±0.5				Specifications	
ANGULAR: .xx ±0.25 ±0°30'				USED ON	
.xxx ±0.1				FL42STH47-1684MA	
UNIT: mm				DWG NO.	
DO NOT SCALE DRAWING				REV	
FIRST ANGLE PROJECTION		SCALE NTS		A	
		SHEET OF		FULLING MOTOR	