

REV	ECN NO.	DESCRIPTION	DRN	APP'D	DATE

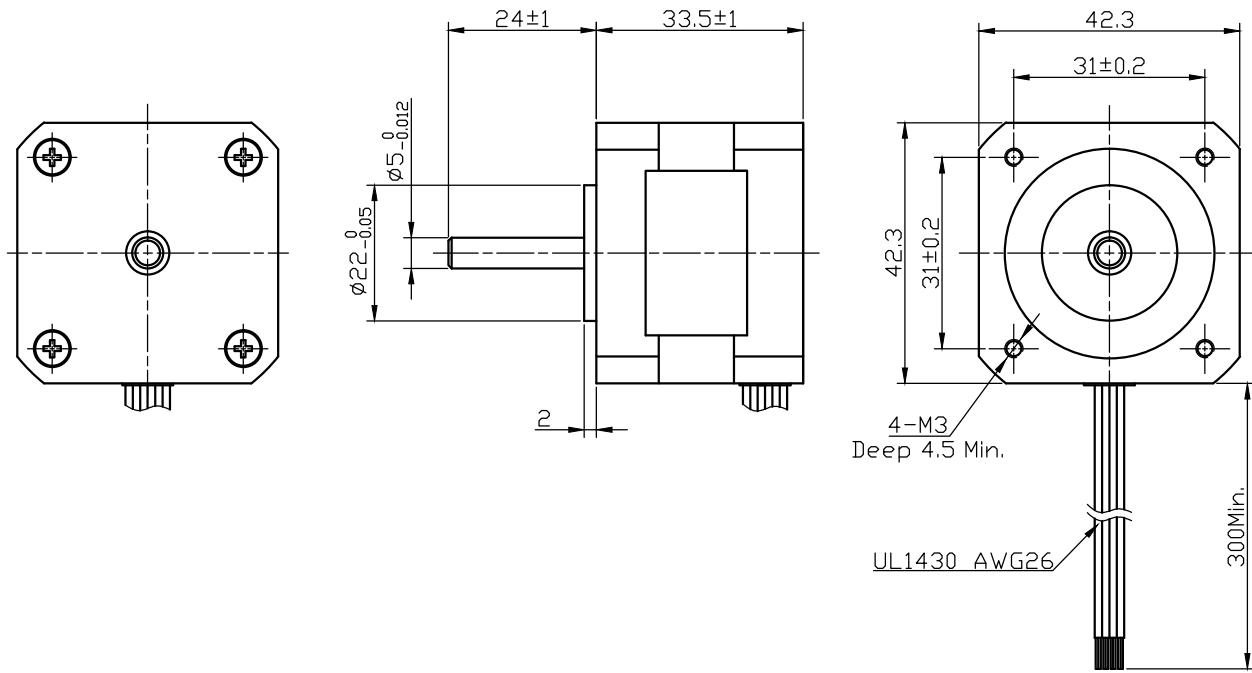

Wiring Diagram(接线图)

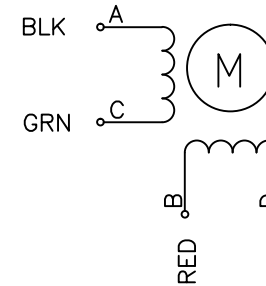

Exciting Sequence (励磁顺序)

CW DIRECTION	STEP	A	C	B	D
↓	1	+		+	
	2		+	+	
	3		+		+
	4	+			+
	1	+		+	

CW, see from flange side
(顺时针, 从法兰侧看)

SPECIFICATION

STEP ANGLE	步距角	0.9°/full step(差步)	PERMISSIBLE RADIAL+AXIAL FORCE (允许的轴向往复力)		
STEP ANGLE ACCURACY	步距角精度	±5%			
NUMBER OF PHASE	绕组相数	2			
RATED VOLTAGE	额定电压	2.8 VDC			
RATED CURRENT	额定电流	1.33 A			
RESISTANCE/PHASE	每相电阻	2.1±10% ohms@20°C			
INDUCTANCE/PHASE	每相电感	4.2±20% mH@1kHz			
HOLDING TORQUE	保持转矩	0.220 N.m			
PULL OUT TORQUE	运行转矩				
BACK EMF	反电动势				
DETENT TORQUE	定位转矩				
ROTOR INERTIA	转子转动惯量	35 g.cm ²			
WEIGHT	重量	200 g			
TEMPERATURE RISE	温升	Less than 80K(小于80度)			
SOURCE VOLTAGE	驱动器电压	24 VDC		AXIAL-FORCE 轴向压力	Fa=10 N Max.
INSULATION CLASS	绝缘等级	B 130°C		DISTANCE 距离	a=20 mm
DIELECTRIC STRENGTH	介电强度	500VAC 1MIN		RADIAL-FORCE 径向压力	Fr=28 N Max.
INSULATION RESISTANCE	绝缘电阻	100M0hm @500VDC	SHAFT RADIAL PLAY 径向间隙	0.02mm Max. @4N	
IP CODE	防护等级	IP30	SHAFT AXIAL PLAY 轴向间隙	0.08mm Max. @4N	
OPERATION AMBIENT	使用环境	Ambient temperature:-20...+50°C, humidity Max. 85%(No condensation)			
STORAGE AMBIENT	存储环境	Ambient temperature:-20...+85°C, humidity Max. 85%(No condensation)			

DESIGN		DATE		P/N.	
				3.1.01.042,***	
UNLESS OTHERWISE SPECIFIED TOLERANCES:				TITLE	
DECIMALS: .x ±0.5				Specifications	
ANGULAR: .xxx ±0.25 ±0°30'				USED ON	
UNIT: mm				FL42STH33-1334MA	
DO NOT SCALE DRAWING				DWG NO.	
MATERIAL				REV	
CONTR.				A	
CHECK				FULLING MOTOR	
APPD				SCALE NTS	
FIRST ANGLE PROJECTION				SHEET OF	